

> **USER MANUAL**

SWIVEL ARM 117



Disclaimer



Do not tow

Towing with the swing arm 117 is strictly prohibited, without exception.

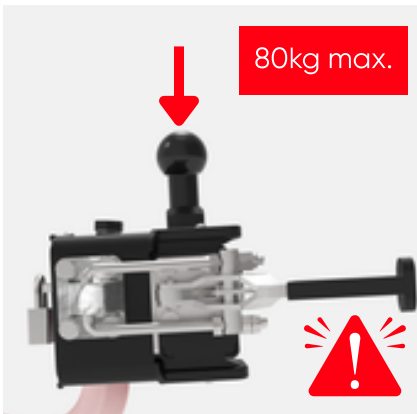

Max load - Swing arm

The swing arm 117 has a maximum payload of 80 kg (including bicycles plus bicycle carrier). Always ensure that the permitted load on the vehicle's rear axle is not exceeded at any time.

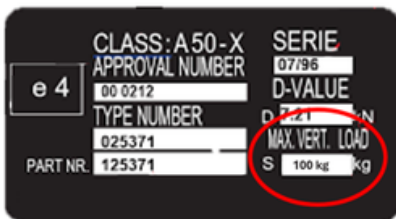

Towbar check

Always respect the maximum vertical load allowed by your towbar (marked "S" on the towbar approval plate). This "S" load includes the swing arm 117 (27,5 kg) plus the bike carrier plus the bikes.

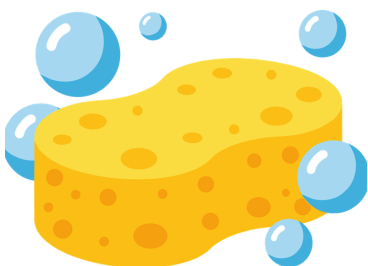

Washing

We recommend rinsing the swing arm 117 with soapy water after use to avoid corrosion.

Informations

In the following cases, the manufacturer declines all liability or warranty in the event of damage

- If the instructions are not followed
- If the product is misused
- If it is handled incorrectly
- If non-SKEP spare parts are used
- If the product is repaired by unqualified persons
- If it is used in a manner contrary to the vehicle manufacturer's recommendations

Orientations :

The swivel arm 117 is available in left and right orientations. For this user manual, it will always be shown in the right orientation. However, all of the information applies to both versions.

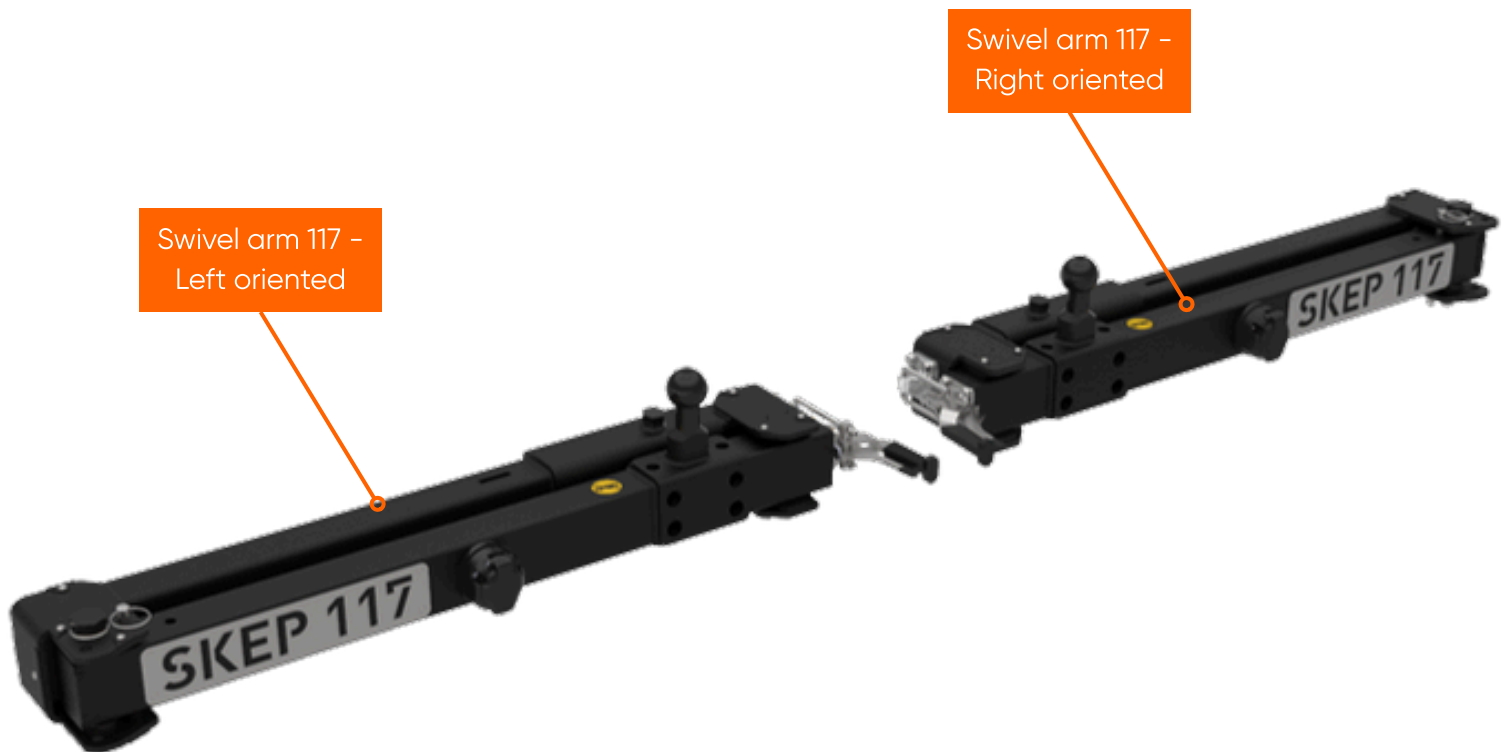

Informations

Warning

The assembly diagram is only a general guideline, due to the existence of several vehicle types. Before tightening all the screws and nuts, ensure that the swing arm 117 is positioned correctly. Before proceeding with installation, read this assembly plan carefully. The contents of these kits, as well as the accompanying assembly guides, are subject to change without notice. We particularly emphasise that if this product is not correctly installed, no right to compensation will be accepted in the event of damage, including claims under product liability legislation. If you have any questions, please do not hesitate to contact your dealer.

Risk of injury if the instructions are not followed!
This user manual contains important information for the safe use of the swing arm 117. Potential hazards are specifically highlighted. Failure to observe these warnings may result in injury or accidents.

SKEP accepts no liability for personal injury, damage to movable or immovable property, loss of profit, or any other damage or loss resulting from improper assembly or use of the swing arm 117, including but not limited to assembly or use not in accordance with these instructions or any other written or verbal instructions from SKEP or an authorised SKEP dealer.

The swing arm 117 must never be modified.

Please consult SKEP or your authorised dealer if you have any questions about the operation, use, or limitations of the product.

Intended use:

The swing arm 117 should only be used with suitable accessories approved for use on public roads. The swing arm 117 is designed for use on asphalt roads. Use of the swing arm 117 is only permitted if it is correctly secured and in perfect technical condition. Intended use also implies compliance with the markings on the nameplate as well as reading and following this user manual.

Any other use is considered improper.

Informations

Safety Instructions for Use of the Swing Arm 117 :

The vehicle must never be moved while the 117 arm is open. Similarly, if the vehicle is lifted, the arm must be closed.

On the road, the driver is responsible for the safety of the vehicle and its load.

National laws on load security take precedence and must always be respected, for example any obligation to mark the load with a warning panel.

Refer to your vehicle's manual and/or registration document for axle load and total weight information.

The maximum load permitted for the swing arm 117, as specified in the assembly instructions, must never be exceeded. The vehicle's own recommended maximum load always takes precedence over the specifications stated in these instructions.

The maximum permitted weight for the swing arm 117, as specified in the assembly instructions, applies whether the vehicle is moving or stationary.

Loads must be properly secured using the means provided by the manufacturer of the rack in accordance with the instructions.

When loading luggage on the swing arm 117, always place heavier or bulkier items as close to the vehicle as possible and as low as possible.

If your vehicle has an automatic boot or tailgate opening function, this must be disabled: the luggage compartment must be opened manually when using the swing arm 117 to avoid damaging the vehicle and/or the swing arm.

If necessary, the load must be supplemented with appropriate lights and warning signs, in accordance with local regulations.

Specific requirements for bicycles

For bicycles with carbon frames or forks, consult the bike rack manufacturer or dealer to ensure compatibility with the swing arm 117.

It is mandatory to use ratchet straps to pre-tension the bicycles once mounted on the swing arm 117, to limit their movement while driving.

All easily removable parts must be removed from the load before transport, especially on bicycles: child seats, baskets, removable locks, or air pumps. This list is not exhaustive. These items could come loose due to increased vibration and air resistance during transport, posing a danger to other road users.

SKEP accepts no liability for vehicle damage occurring during the assembly and/or use of the swing arm 117.

Follow the recommendations of the accessory manufacturer (bike rack, ski carrier, etc.) installed on the swing arm 117.

Informations

Before the journey

- Check the arm is closed
- Check the pin is inserted in its hole
- Check the toggle latch is closed
- Check all loads are properly secured
- The load must not exceed the width of the vehicle

Inspection upon receipt

Before proceeding with installation, check that the contents are complete and undamaged:

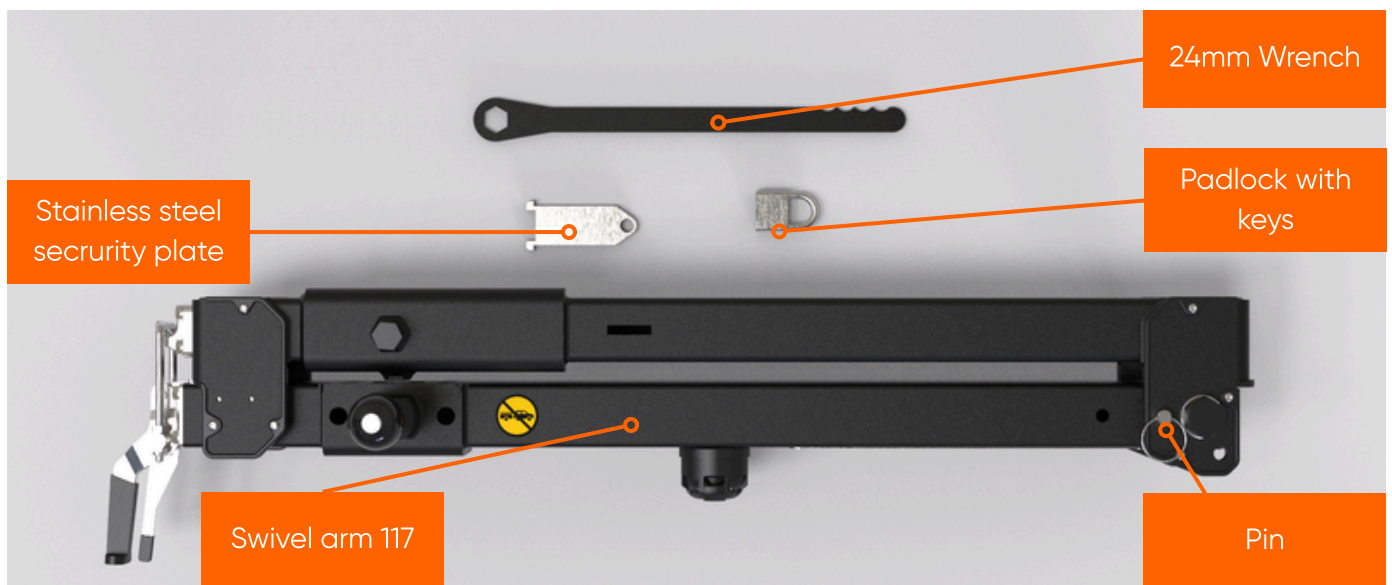

- Read the user manual carefully
- Follow the safety instructions in this user manual
- Keep the user manual to hand

The product must not be used in the following cases:

- If the vehicle is damaged
- If the vehicle has been modified or transformed
- By children or by persons who are unable to assess the dangers linked to use of the carrier system

Toggle latch

Check and adjust the toggle latch



On-load adjustment

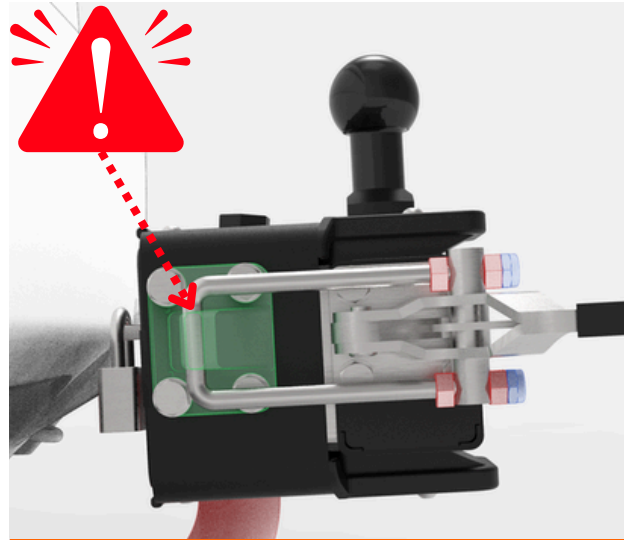

The toggle latch does not touch its hook

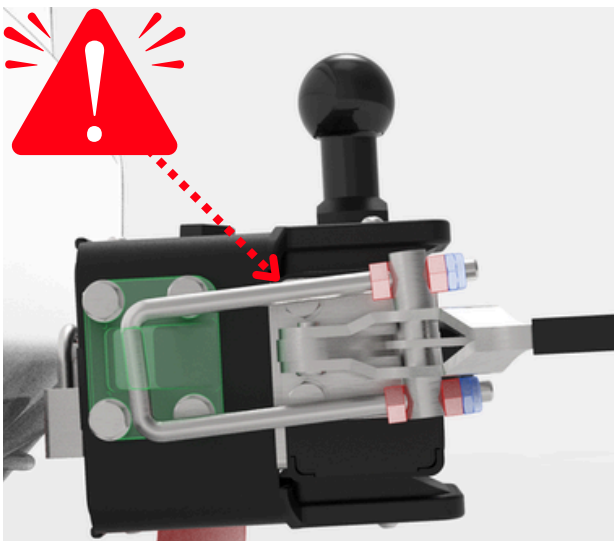

The toggle latch is not straight

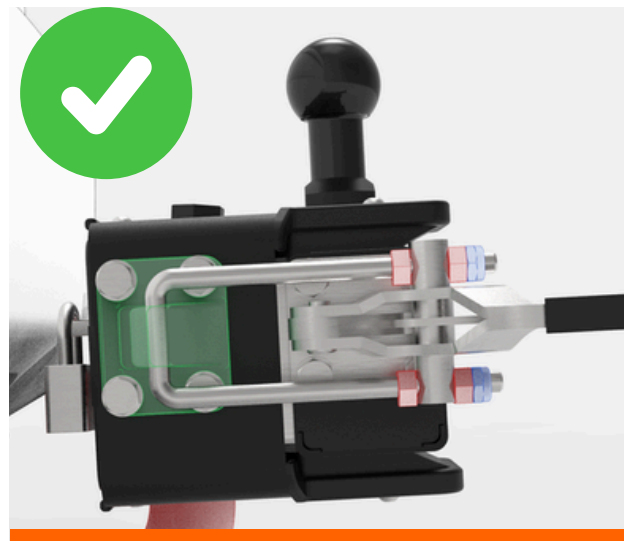

The toggle latch is aligned, touching the hook all the way along.

For the clamp to work properly, it must be:

- Aligned with its hook
- In contact along the entire length of its hook
- Requiring considerable force to tighten

Important! Adjustments must be made under load, i.e. with your bike rack and bikes in place.

We will now look at how to adjust the clamp if necessary.

If you make a new adjustment, it must always be done while charging.

Toggle latch

Always close and lock the Toggle latch

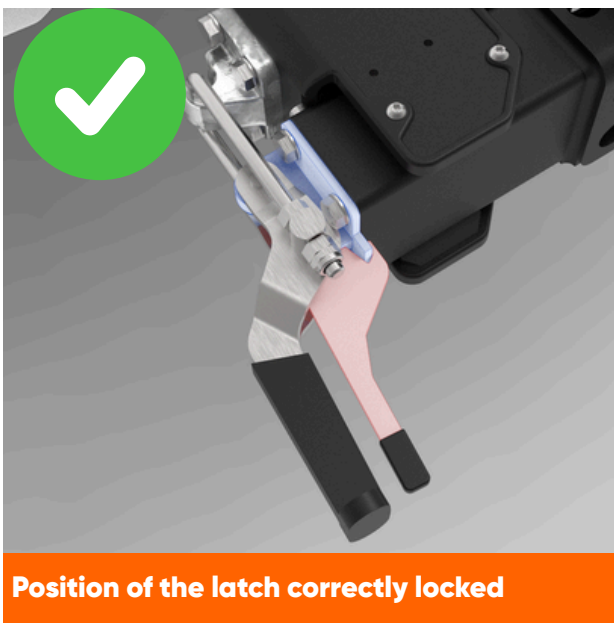
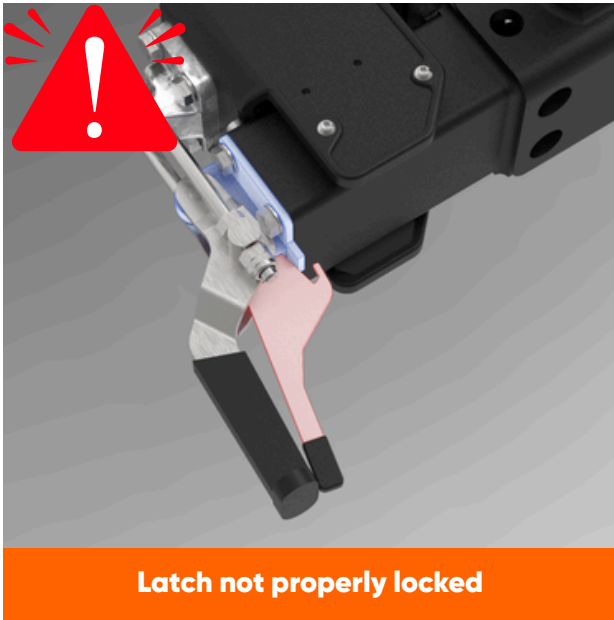

If the supplied lighting is insufficient, the load must be marked as follows:

- With a white light to the front
- With a red light to the rear
- Maximum 1500 mm above the ground
- If the vehicle's third brake light is obscured by the load, an additional third brake light must be installed.
- If your vehicle length exceeds 6 metres, install a clearance light.

Locking pin

Always ride with the locking pin in place



- You must drive continuously with the locking pin in the 0-degree locking position.

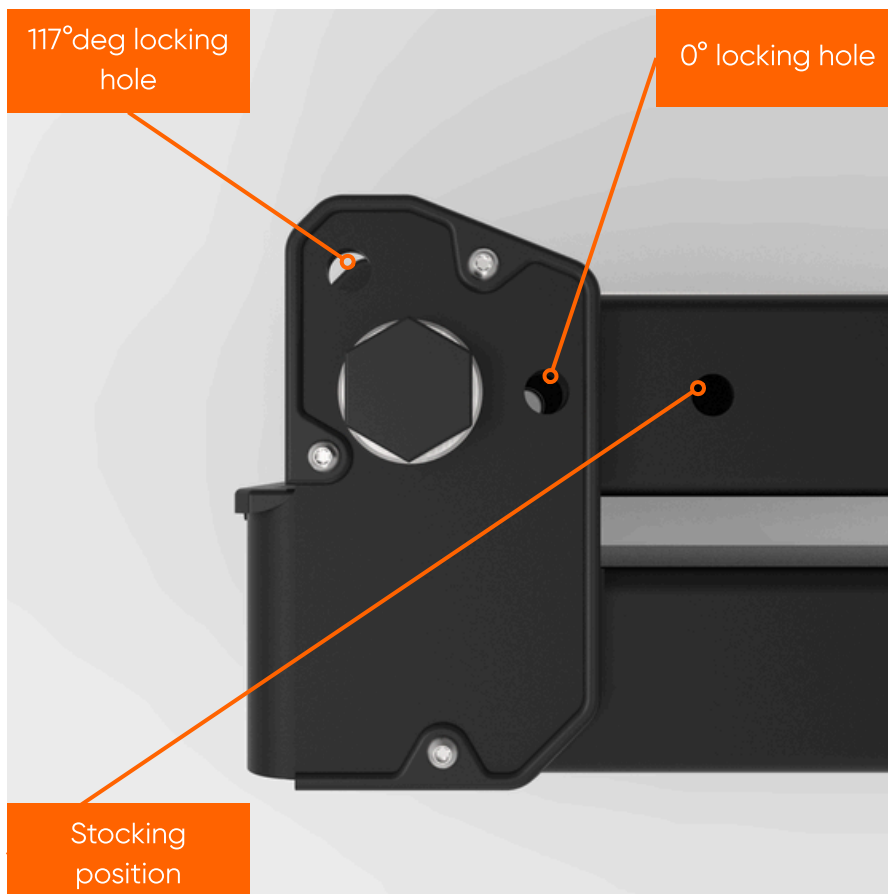

Usage

During the journey :

While using the carrier system, the following points must be observed:

- Regularly check the loading situation using the rear-view mirror. After each use of the swing arm 117, check it is correctly fitted after travelling a short distance (10 km), then at regular intervals. In case of unusual noise, load shifting and/or swing arm movement, abnormal vehicle behaviour or any other unusual detail, stop and check the swing arm 117 and the load according to the assembly instructions. After use on cobbled or degraded roads, carry out the same checks.
- It is the sole responsibility of the driver to ensure the good condition of the swing arm 117 and the proper securing of the load, even if installed by a third party
- The speed of 130 km/h must not be exceeded
- Due to increased lateral area, greater sensitivity to crosswinds must be expected
- Due to changes in load distribution, handling and braking behaviour may change. It is advisable to reduce speed, especially in corners, and to allow for longer braking distances
- Use of the swing arm 117 may increase the total length and/or height of the vehicle. The luggage itself, especially bicycles, may increase the overall width and height of the vehicle. Take extra care when reversing or entering garages, ferries, etc.
- It must not be used off-road
- Do not drive through a car wash with the carrier fitted
- Ensure the driver's field of vision is clear in all directions
- On long journeys, check every 500 km that the carrier and its accessories are securely fastened and the load is properly secured. If road conditions are rough, check more often

Usage

During the journey (continued) :

- Replace any damaged or worn components immediately. During transport, all levers, bolts and/or nuts must be tightened according to the assembly instructions
- The 117 swing arm must always be in the closed and in the locked position for transport. The toggle latch must always be locked and the pin engaged in its hole. If using locks or padlocks, remove the keys and keep them inside the vehicle during transport
- Depending on the accessory fitted to the swing arm 117, the rear lights may be blocked. In this case, the user must fit additional lights. It may also be necessary to add a number plate, fixed to the accessory, in accordance with local legislation. The user is responsible for complying with all applicable load regulations in each country of travel: width, length of the device, lighting and signalling requirements. The number plate and lights must remain visible. Check compliance with your plate
- Vehicle speed must be continuously adjusted to match the load and road conditions, such as road type and quality, weather conditions, traffic density, and applicable speed limits, but must never exceed 130 km/h. Road traffic regulations must always be observed
- Drive slowly over speed bumps, at a maximum of 10 km/h
- Note that wind noise may occur during transport, varying depending on the vehicle and the load

Usage

Maintenance:

Clean the swing arm 117 regularly with warm water and car shampoo, particularly if used in coastal regions (due to salt) or in winter when roads are salted.

Remove the swing arm 117 before using an automatic car wash.

Once removed, the swing arm 117 should be stored in a dry place and its components kept properly stored.

In case of wear or loss of components, only use original SKEP spare parts. Please contact your dealer or the manufacturer.

To receive spare parts quickly and save time, remember to provide the relevant product information when placing an order or making a request.

The swing arm 117 should be maintained as follows:

- Clean with warm water and bodywork shampoo
- Remove salt and dirt after each use
- Spray silicone lubricant into the index pin and the toggle latch axis every month
- If necessary, lubricate the swing arm pivot axle with multipurpose oil

Dimensions & weight

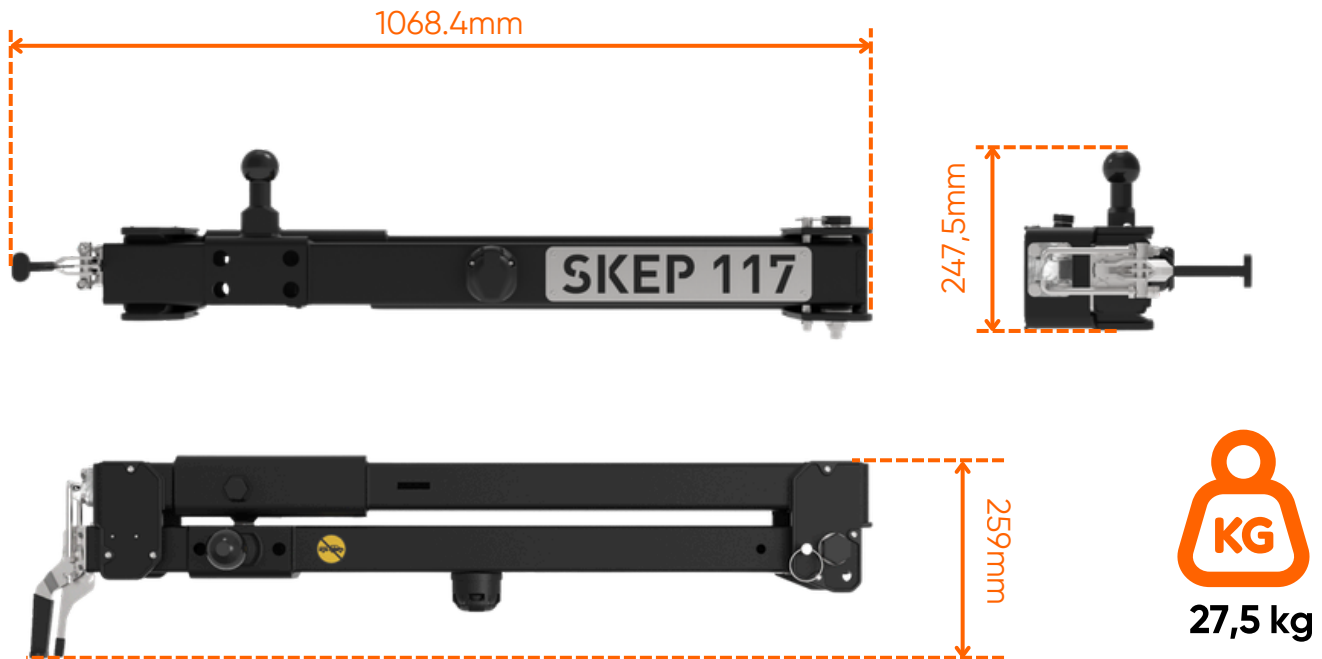

90deg

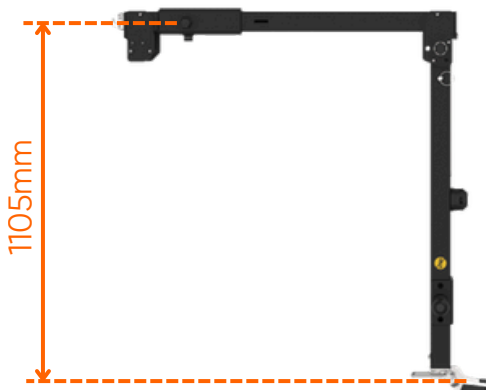

180deg

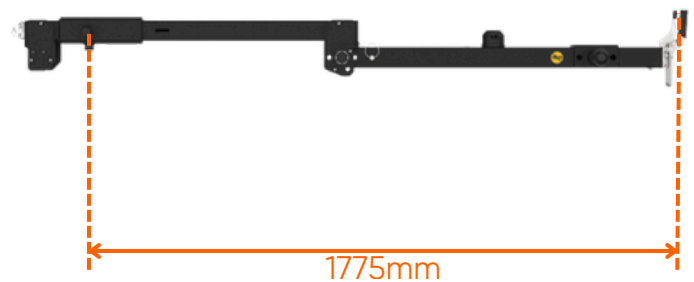

Be careful when opening, as the equipment installed on the device may touch your vehicle. We therefore recommend opening it to a maximum of 117°.

Detail

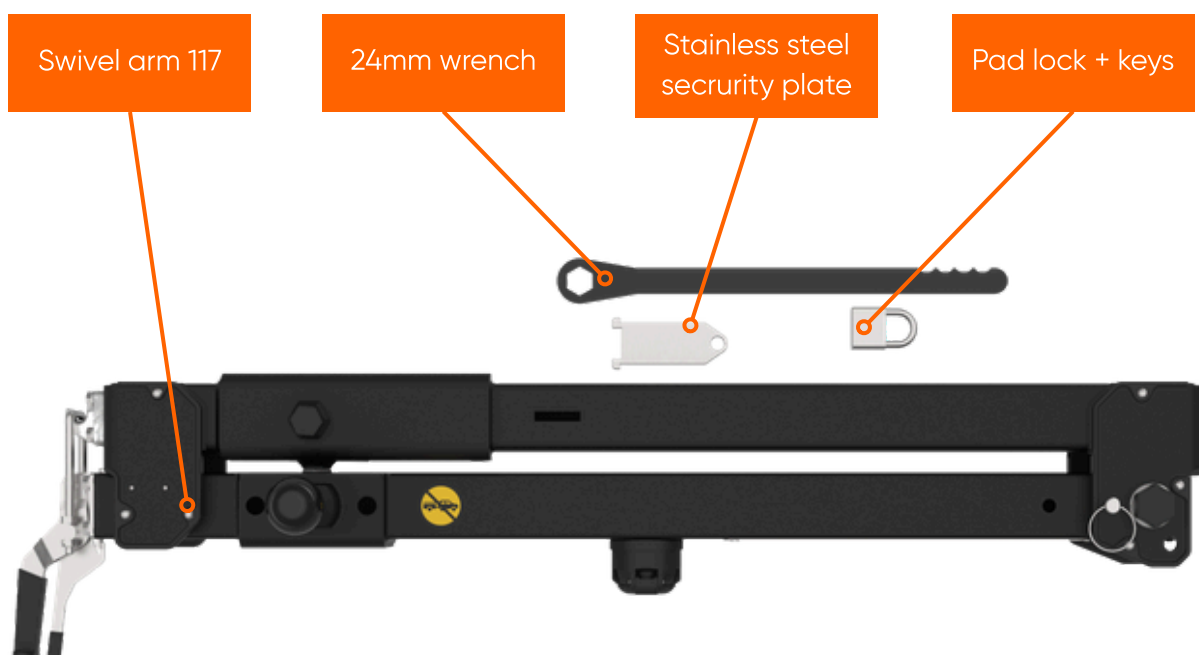

Tools

- The only tool required is the 24mm wrench, which is supplied.



Assembly steps

1. Unpacking and preparation

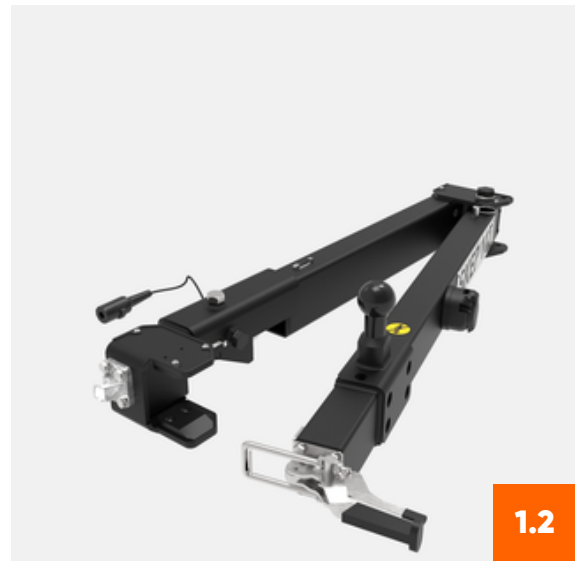

- Unpack the product completely.
- Place the security plate in the storage location.
- Place the locking pin in its location.
- Remove the screw cover from the upper M16 screw.

2. Installation on the vehicle



- Position the 117 above the towball with the arm partly open
- Engage the 117 around the towball

Assembly steps

3. Install the security plate



- Tilt the 117 to engage the stainless-steel security plate
 - Move the 117 up and down to make it easier to insert
 - Push the pin fully home (the hole in the pin must come through on the other side of the 117)
-

Assembly steps

4. Angle adjustment

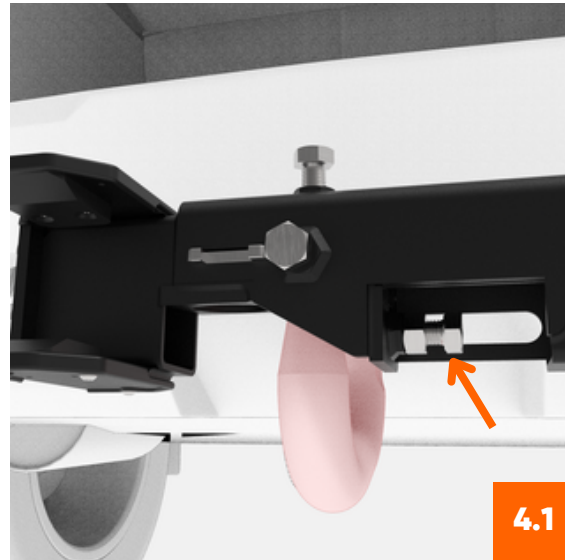

- Tighten the M16 bolt (using the supplied tool) so that the 117 is straight. It can be slightly inclined upwards to counteract the elasticity linked to opening the arm.



Once the adjustment has been made, you will not need to repeat it on this vehicle. The angle setting remains the same if you dismantle/reassemble the system.

If you switch to another vehicle, you will need to adjust the angle setting for that vehicle

Assembly steps

5. Clamping



Upper screw

- Tighten the upper M16 screw (using the supplied tool) until the 117 is immobile

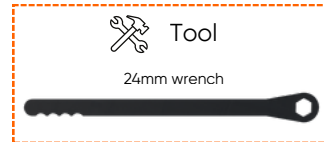

Front screw

Tighten the front M16 screw (using the supplied tool) until the 117 is immobile

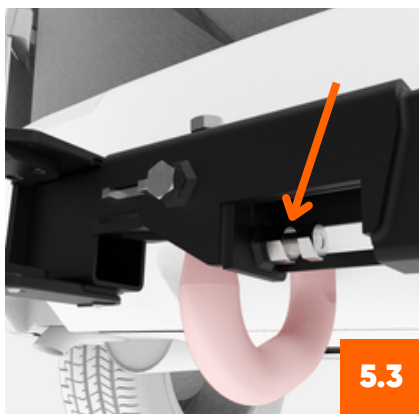
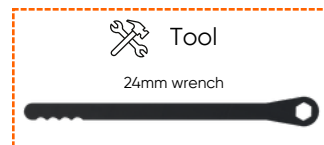

Side nut

Tighten the side lock nut to secure the side screw. (using the supplied tool)

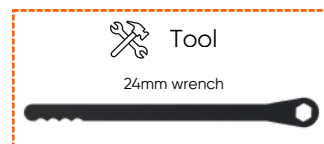

Plastic Cap

Fit the black plastic cap on the upper nut

6. Tightness check

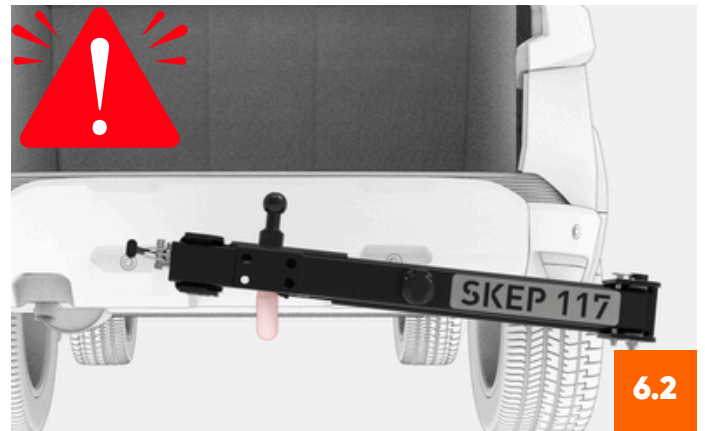
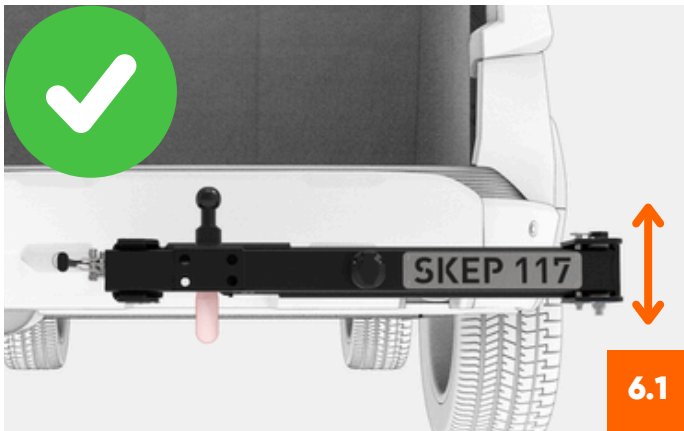

Once tightened, apply upward and downward pressure to the end of the Swivel Arm 117. If the Swivel Arm 117 moves and separates from the tow ball, the screws are not tight enough. Repeat the steps in section 5.

6

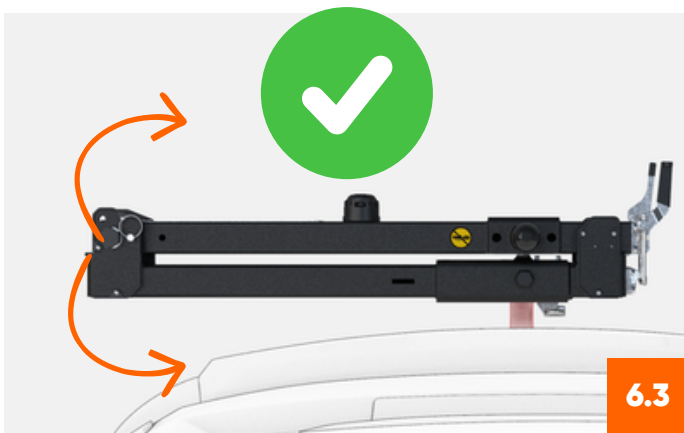

Apply force to the end of the Swivel Arm 117, rotating it forwards and then backwards. The arm must not rotate in relation to the coupling ball. If it does, repeat the steps in section 5

5

Assembly steps

7. Finalisation



Normal inclination

You may notice that the swivel arm 117 is oriented as shown in image 7.1. This is completely normal. This is to maximise your angle of departure. If, on the other hand, the swivel arm 117 tilts backwards, then the front screw is not tight enough. Start again from step 5.



Fixing socket

- Plug the 13-pin socket of the swing arm into that of your vehicle
- If necessary, use a 7-to-13 pin adaptor if your vehicle is equipped with a 7-pin wiring harness
- Do not allow the wiring harness cable to hang down, as it may get torn out while driving

If your vehicle-side socket falls directly opposite the 117, please contact us so we can find a technical solution.



Padlock

To secure your 117 against theft, you can use the supplied padlock for extra security



Security Pin

Before driving. Insert the security pin into the hole at 0°.

Toggle latch opening/closing

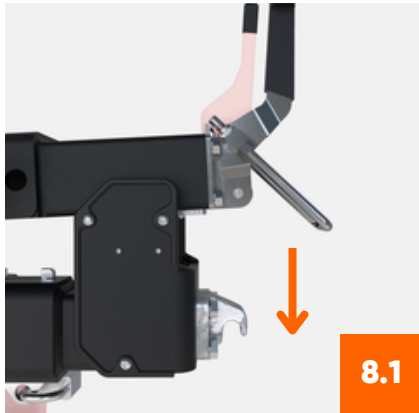

Closing

To close the arm the stirrup must be raised so that it does not catch on the hook.

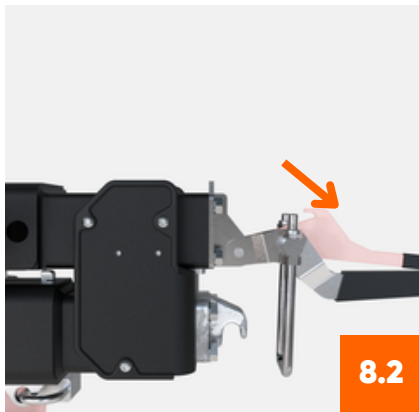

Security lever

Keep the safety lever engaged and place the bracket in the hook.

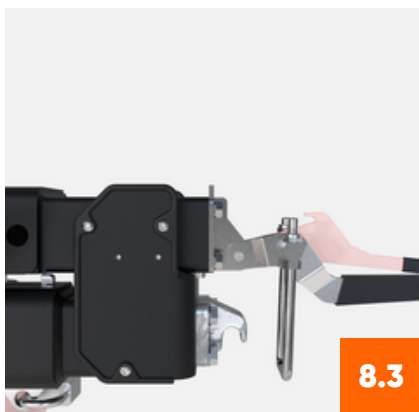

Hook

Operate the safety lever and then rotate the toggle latch so that the stirrup passes through the hook.

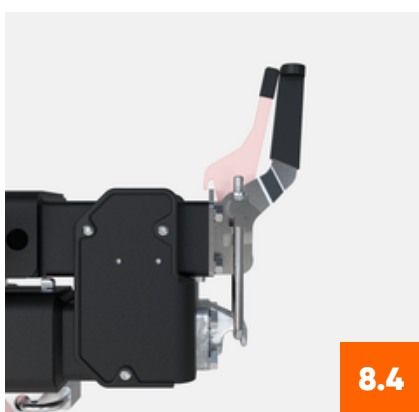

Tightening and securing

Tighten the toggle latch and then release the safety lever. It must be fully engaged. To check, try to open the toggle latch without pressing the safety lever. If you cannot open it, the safety mechanism is working properly.

8.4 To open, follow the steps in reverse order.

Disassembly



9.1

Electric Socket

Disconnect the plug and remove any equipment mounted on the swivel arm 117.



9.2

Loosening

- Remove the cap.
- Loosen the screw on the front and the screw on the top using the wrench provided.
- It is not necessary to loosen the screw completely.
- The swivel arm 117 should be able to move once the two screws have been loosened.
- Do not loosen the side screw.



9.3

Security plate

Remove the padlock and then remove the security plate. Tilt the swivel arm 117 to make this easier.



9.4

Storage

Place the security plate in its storage location. Store the swivel arm 117 away from moisture.

Practical aspects

24mm wrench

We recommend that you keep the 24mm wrench in your vehicle.



13-pin socket

The 13-pin socket allows you to connect your equipment (such as a bike rack) directly to the arm.

If necessary, use a 7-to-13 pin adaptor if your vehicle is equipped with a 7-pin wiring harness



Protect the ball

Use the ball cover when not in use.



Issues/Solutions



Lean forward

If the pivoting arm 117 tilts backwards after rolling, this means that it is not tight enough. Repeat the tightening steps in section 5.

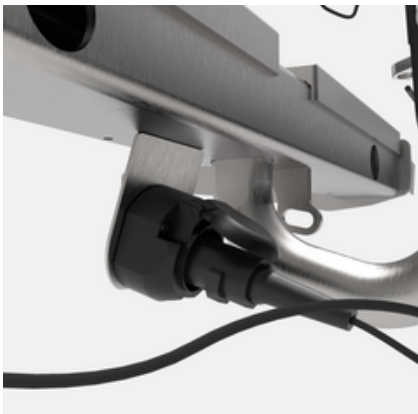

The 117 spins on the ball

If the swivel arm 117 rotates around the towball when you are driving, it means that it is not tight enough. Repeat the tightening steps described in section 5.

Clash

Your tailgate/barn doors may hit the tow ball attached to the Swivel Arm 117. In this case, you can slightly open the arm to allow the tailgate to pass. The simplest solution is to remove the Swivel Arm 117 when not in use.



Usage

Warranty

SKEP provides a warranty on its products for a period of two years from the date of delivery, in accordance with European Directive 1999/44/EC and Law 23/2003. The warranty is limited to the replacement of defective goods and will under no circumstances cover damage caused by improper use. It is forbidden to make any modifications or transformations to the chassis extension. Failure to comply with this will result in the immediate cancellation of product approval and warranty.

WARNING ! SKEP is not responsible for any damage or deterioration caused by misuse or incorrect assembly.

THANK YOU

SKEP
DESIGNED FOR ADVENTURE